

# PADLOCK ALARM

Vibration and Anti-Tamper Padlock Alarm

Product Code: EL00030

## Introduction

The Padlock Alarm is a dual function security device that can be used as a normal padlock, or as an alarm. As a normal padlock, it provides sturdy and weatherproof protection. As an alarmed padlock, it detects vibration and tampering, releasing a piercing 110dBs siren to deter intruders. Users can choose the method by simply adjusting the shackle direction.

## Operation of the alarm

**Note:** all new Padlock Alarms come pre-set to non-alarm mode.

To operate the Padlock Alarm, first install the batteries. The alarm uses 6 x LR44 cell batteries (included). To install the batteries, insert the key and turn clockwise to remove the shackle. Remove the 2 screws in the shackle (see Diagram 1). Remove the cover and insert the batteries noting the correct polarity (shown inside the compartment, see Diagram 2). Replace the cover and screws in the shackle holes. It is recommended that the batteries are tested regularly,

### 1. To operate the padlock as an alarm:

You will notice a groove on the inside of the shackle. When replacing the shackle into the lock, have this groove facing away from the key port (see Diagram 1). Push the shackle down firmly until it clicks, the lock will beep once to confirm setting. The vibration/tamper detection will be active within 10 seconds. Remove the key and leave the lock.

After setting, if the lock is tampered with or detects vibration, the alarm will beep 3 times as a warning. If further tamper or vibration is detected within 10 seconds of this warning, the 110dBs siren will sound for 10 seconds. The siren will sound instantly after each further detection, for 10 seconds each time, until the unit is unlocked with the key.

The siren will always stop instantly whenever the unit is unlocked with the key.

If opening your lock with the key during its alarmed state, you will likely hear the 3 beep warning. As long as you remove the shackle within 10 seconds, the siren will not activate. The siren will never activate whilst the shackle is removed.

Diagram 1

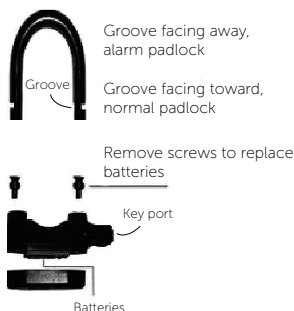

Diagram 2

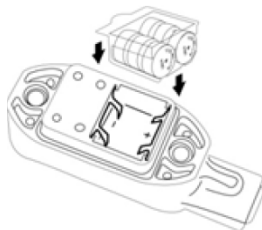

Diagram 3



## 2. To operate the padlock as a normal padlock:

When replacing the shackle into the lock, have the groove facing toward the key port (see Diagram 3) The shackle will slip straight in and no beep will sound. Lock and remove the key, your unit is a fully functioning, heavy duty padlock.

### Note:

If the lock is used on a vehicle or equipment that is in motion, only use as an ordinary padlock. When the vehicle or equipment is stationary, you can safely use the padlock as an alarm.

### CAUTION

- When testing the alarm, make sure you hold it at least at arm's length away from your ear.
- The power source or propellant has a finite / limited life.
- DO NOT MODIFY THE ALARM.
- The alarm should be kept out of reach and audible range of children and pets.
- Do not mix old and new batteries. Always observe proper polarity when inserting the batteries.
- If the alarm is out of use for extended periods of time, remove the batteries to avoid leakage.

### Note:

Performance may be adversely affected following prolonged exposure to extreme temperatures.

## WARNING

The high output siren fitted to this quality alarm may cause ear damage if used at close range for a prolonged period of time. Keep away from children and pets ears. This product is designed for use as a deterrent; it does not guarantee protection or personal safety.